



ONYX

RAM-T

Modular Air Delivery Solution

RAM-T, Rigged Alternate Method Tandem, is a smart modular air delivery solution. Designed to allow the airdrop of any payload including the complete inflatable watercraft, including engine, fuel, and inflation system enclosed in one delivery, RAM-T enables warfighters to rapidly deploy payloads within minutes of landing. It can be deployed in multiple air delivery configurations, such as tethered tandem, conventional, or guided parachute systems. RAM-T is modular and highly versatile, making it ideally suited for the delivery of payloads utilizing the custom-fitted inflatable barrel enclosures. From unmanned systems, communications equipment, defense technologies to humanitarian aid, soft goods, and more, RAM-T is suitable for getting equipment into hard-to-reach places around the globe.

[ONYX-IND.COM/RAMT](https://onyx-ind.com/ramt)

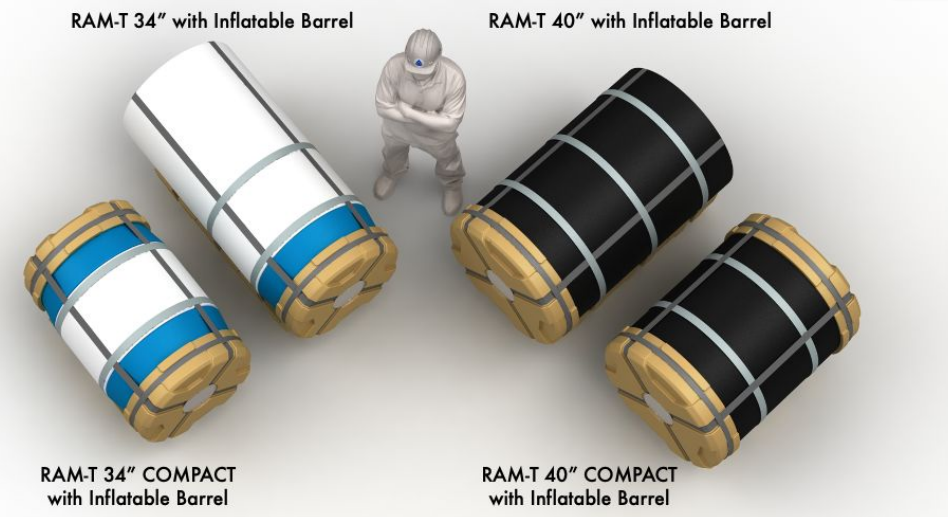

PRODUCT SPECIFICATIONS

/ Suggested Max & Min Exit Weight	RAM-T 40: 1,000 lbs / 550 lbs (450 kg / 250 kg) RAM-T 34: 1000 lbs / 400 lbs (450 kg / 181 kg)
/ Straps & Hardware	Rated to 10,000 lbs (4,535 kg)
/ Strap System	Milspec Type 7 Nylon
/ Dimensions	RAM-T 40L: 40" x 64"-72" (102 x 163-183 cm) RAM-T 40C/B: 40" x 52"-72" (102 x 132-173 cm) RAM-T 34L: 34" x 64"-72" (86 x 163-183 cm) RAM-T 34C: 34" x 64"-72" (86 x 163-183 cm)
/ Device Weight	RAM-T 40L: 156 lbs (71 kg) RAM-T 40C/B: 171 lbs (78 kg) RAM-T 34L: 154 lbs (70 kg) RAM-T 34C: 124lbs (56 kg)
/ Wheel Carriage Frame	316 Stainless Steel
/ Wheels	80a Polyurethane
/ Wheelbase Blocks	Cross-Link High Density Polyethylene
/ Inflatable Barrel Options	RAM-T 40: 40" x 60" (102 x 152 cm) RAM-T 40: 40" x 64" (102 x 163 cm) RAM-T 40: 40" x 68" (102 x 173 cm) RAM-T 34: 34" x 60" (86 x 152 cm) RAM-T 34: 34" x 64" (86 x 163 cm) RAM-T 34: 34" x 68" (86 x 173 cm)

HIGHLIGHTS

- Parachute attachments for smart or "dumb" parachute delivery systems.
- Base cap provides uniform presentation to the airstream and to protect the payload and container on surface impact.
- Multi-drop configurable harness system.
- Customizable wheeled frame and modular carriage blocks.
- Compatible with Kraka, WING, Zodiac & Sillinger boats.

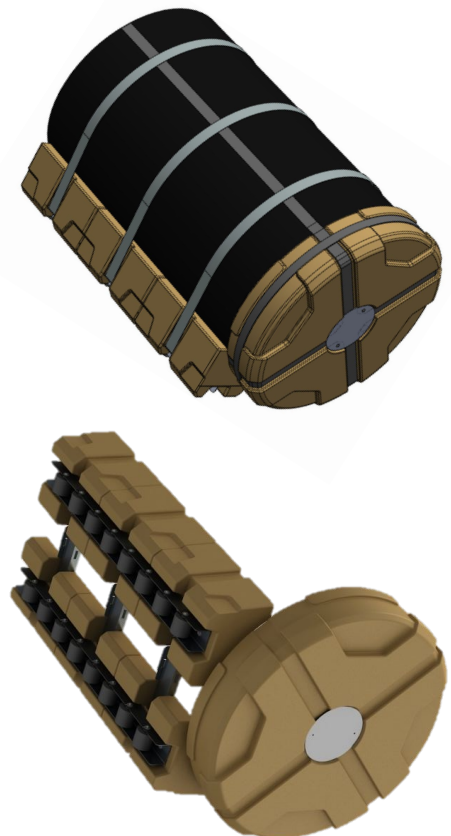

Training Available CONUS & OCONUS | Color Customizable | Discounts available on bulk purchases | Suggested complete system available upon request

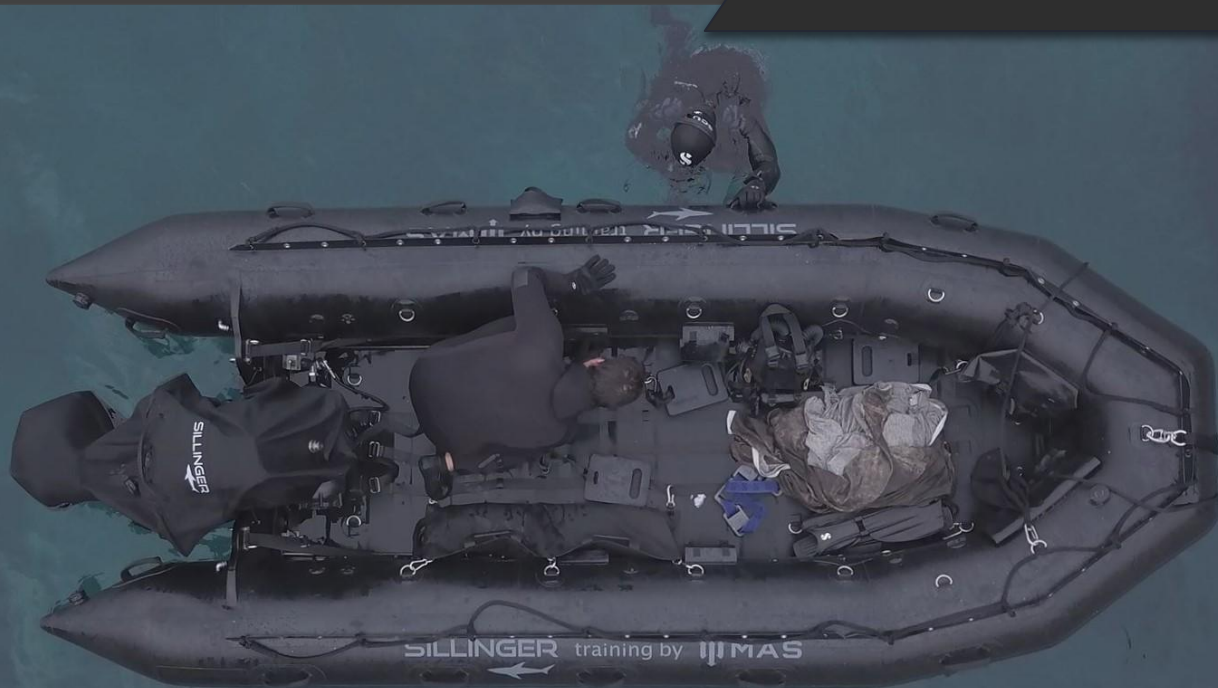

Deploy Sillinger Boats with RAM-T

- The 45" SRD (Sillinger Rapid Deployment) is a state-of-the-art rapid deployment boat, engineered for intervention units to operate swiftly, efficiently, and discreetly under varied conditions, day or night. Its design permits seamless airdrop and underwater deployment, irrespective of sea challenges, making it versatile in the field.
- With dimensions ranging from 3.8 m to 5.25 m, the boat utilized can fit the end user's exact specifications. The groundbreaking SUB "underwater cache" feature enables the vessel to remain submerged for stealth missions, while its design fully supports airdrop, submarine deployment, or retrieval. One of its standout features is its rapid deployment capability, taking less than 5 minutes to sink or resurface, coupled with the ease of operation by a single person.



Learn more [here](#)

Training Available CONUS & OCONUS | Color Customizable | Discounts available on bulk purchases | Suggested complete system available upon request

Deploy Kraka Board MIL 250, 400, and 600 with RAM-T34



The Kraka board is a meticulously designed piece of equipment, built to withstand the rigors of real-life military situations, where capacity and reliability are paramount.

→ Manufactured using a 20 cm thick CSM Hypalon coated drop-stitch fabric and bolstered with an additional outer layer of 1500 gsm Hypalon, its topside features a matt finish to minimize glare. A critical addition to its design is the emergency "take me home" button near the throttle, allowing for a software override or a complete battery drain to achieve the extra range necessary for a safe extraction.

→ Available in Black, military grey, or army green, Kraka's compatibility with the RAM-T system further enhances its usability. This integration allows for seamless air delivery using RAM-T's adaptable, modular, and customizable platform, offering a comprehensive solution for remote deployments and emergency situations.



Learn more [here](#)

Training Available CONUS & OCONUS | Color Customizable | Discounts available on bulk purchases | Suggested complete system available upon request



Deploy Wing Special Operations Boats with RAM-T



- Compatible with Wing's P4.2, P4.2 Rescue & P4.7 boats
- Wing hull design creates hydrodynamic lift and compartmentalizes the running surface to reduce vacuum - quicker to plane and greater speeds with heavier loads
- Large interior space
- Polyurethane Fabric used throughout for longer life and 2-3 times the puncture resistance of Hypalon or PVC
- Thermo welded seams for a joint as strong as continuous material
- Composite transom; lighter weight and stronger than aluminum, will not decay like wood
- California made with U.S. materials and Berry Amendment compliant



Wing Boats: Learn more [here](#)

Training Available CONUS & OCONUS | Color Customizable | Discounts available on bulk purchases | Suggested complete system available upon request

AVAILABLE RAM-T ACCESSORIES

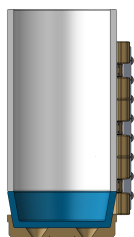

RAM-T Inflatable Barrel

A robust containment system is engineered using a 1.3" (3.3cm) or 2.6" (6.6cm) thick CSM Hypalon coated drop-stitch fabric for the ultimate in protection and secure housing. Designed to accommodate a wide variety of payloads, including but not limited to unmanned systems, communications, weapon systems, and soft goods. The inherent protective properties of the material ensure safe deployment of these items for both military and civilian applications.

Included with RAM-T 34C, RAM-T 34L

Optional accessory for RAM-T 40C/B & RAM-T 40L



RAM-T Ballast System

Our modular Ballast System revolutionizes the aerial delivery system by allowing for scaled, measured weight to be added, ensuring a safe and stable flight for the systems in deployment. Specifically designed for flexibility, the ballast bags come in 25lb, 50lb, 100lb (11.34kg, 22.67kg, 45.35kg) sizes and can be filled with a variety of materials including sand, fuel, water, or any granular material. This enables precise control over the weight distribution, catering to specific needs and flight requirements.



RAM-T Water Resistant Liner

The Payload Water Resistant Liner offers essential protection for aerial deliveries, acting as a robust barrier against water and dust. It ensures critical payloads remain safeguarded during transit, enhancing the reliability of each delivery and guaranteeing pristine arrival conditions.



RAM-T Stabilization System

Our modular inflatable Payload Stabilization System enhances the stability of aerial deliveries. Filled with compressed air, the "seat cushion" bags prevent horizontal shifts, while the cylinder fill bag restricts vertical movement. Positioned between the payload and the container, they maintain payload integrity, ensuring safety and stability during transit.

Training Available CONUS & OCONUS | Color Customizable | Discounts available on bulk purchases | Suggested complete system available upon request

CHOOSING THE RIGHT RAM-T FOR YOUR MISSION



MINIMUM PAYLOAD EXIT WEIGHT	PAYLOAD INNER DIMENSIONS (ID)	RECOMMENDED PACKAGE
550lb (250kg)	52" L x 36" W (132cm x 91 cm)	RAM-T 40C/B *with necessary accessories
550lb (250kg)	64" L x 36" W (163cm x 91cm)	RAM-T 40L *with necessary accessories
400lb (181kg)	58" L x 30" (cm L x 76cm)	RAM-T 34C *with necessary accessories
400lb (181kg)	64" L x 30" W (163cm x 76cm)	RAM-T 34L *with necessary accessories

IMPORTANT: When conducting tandem operations always act in accordance with unit-specific regulations, standard operating procedures, and guidelines.

Training Available CONUS & OCONUS | Color Customizable | Discounts available on bulk purchases | Suggested complete system available upon request

RAM-T FEATURES COMPARISON



FEATURES	RAM-T 34L	RAM-T 34C	RAM-T 40L	RAM-T 40C/B
Inflatable Barrel Included (Add-on Available)	✓	✓	✗	✗
Double End Cap (Ad-on Available)	✗	✗	✗	✓
Deployment of WING's P4.2, P4.2 Rescue, and P4.7 Inflatable Boats	✓	✓	✓	✓
Deployment of Kraka 250, 400 & 600 Jet Board Models	✓	✓	✓	✓

IMPORTANT: When conducting tandem operations always act in accordance with unit-specific regulations, standard operating procedures, and guidelines.

Training Available CONUS & OCONUS | Color Customizable | Discounts available on bulk purchases | Suggested complete system available upon request